

GETTING TO THE B-CC REGIONAL SERVICES CENTER

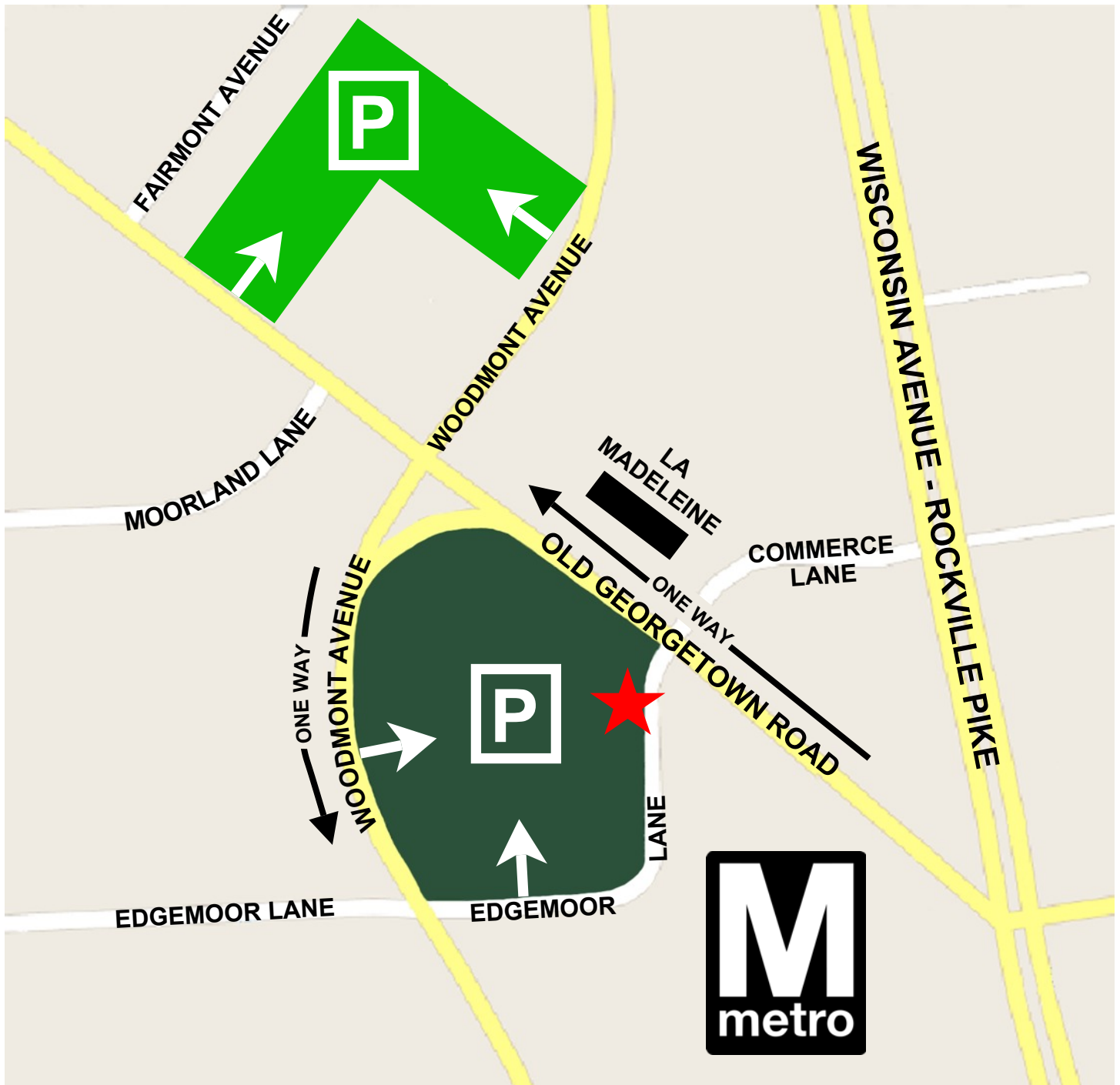

BCC-RSC STREET LEVEL ENTRANCE



UNDERGROUND PARKING (980 SPACES, CASHIER)



ABOVE-GROUND PARKING (1100 SPACES, POF)

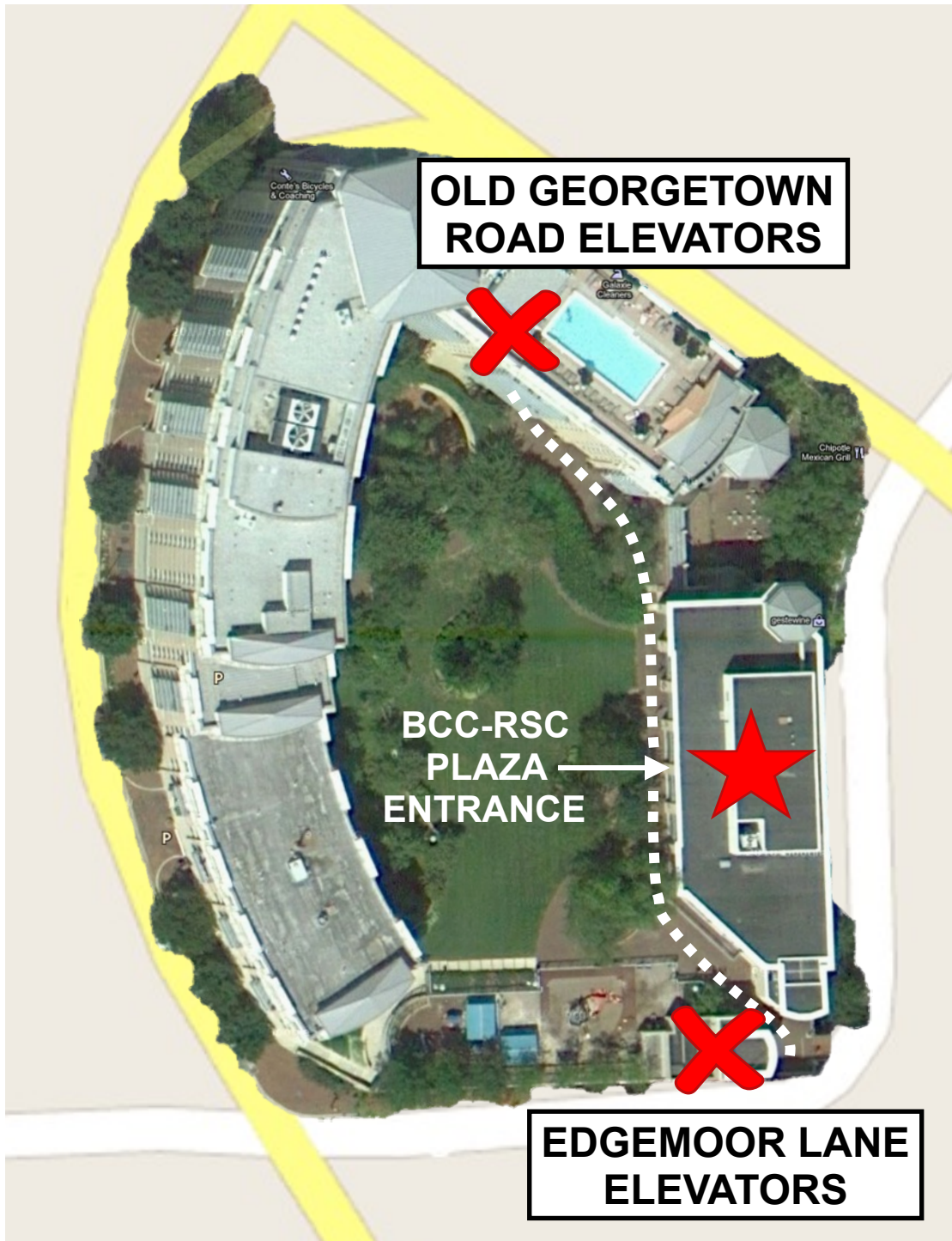

OLD GEORGETOWN ROAD ELEVATORS

BCC-RSC PLAZA ENTRANCE

EDGEMOOR LANE ELEVATORS

OLD GEORGETOWN ROAD ELEVATORS (NORTH)

- SELECT "P" (PLAZA).
- WHEN THE ELEVATOR OPENS, TURN RIGHT, THEN VEER LEFT ALONG THE BRICK PATH, HEADING TOWARD THE CENTER OF THE BRICK BCC-RSC BUILDING ON THE LEFT.
- ENTER THE BCC-RSC BUILDING (FIRST FLOOR). TAKE THE ELEVATOR TO OASIS ON THE SECOND FLOOR.

IF YOU'RE PARKED IN THE UNDERGROUND GARAGE, YOU SHOULD ENTER BCC-RSC FROM THE PLAZA LEVEL. THERE ARE TWO GARAGE ELEVATORS THAT WILL TAKE YOU TO THE PLAZA:

OLD GEORGETOWN ROAD EDGEMOOR LANE

EDGEMOOR LANE ELEVATORS (SOUTH)

- SELECT "P" (PLAZA).
- WHEN THE ELEVATOR OPENS, TURN LEFT, THEN VEER LEFT ALONG THE BRICK PATH, HEADING TOWARD THE CENTER OF THE BRICK BCC-RSC BUILDING ON THE RIGHT.
- ENTER THE BCC-RSC BUILDING (FIRST FLOOR). TAKE THE ELEVATOR TO OASIS ON THE SECOND FLOOR.

SECOND FLOOR OF B-CC REGIONAL SERVICES CENTER

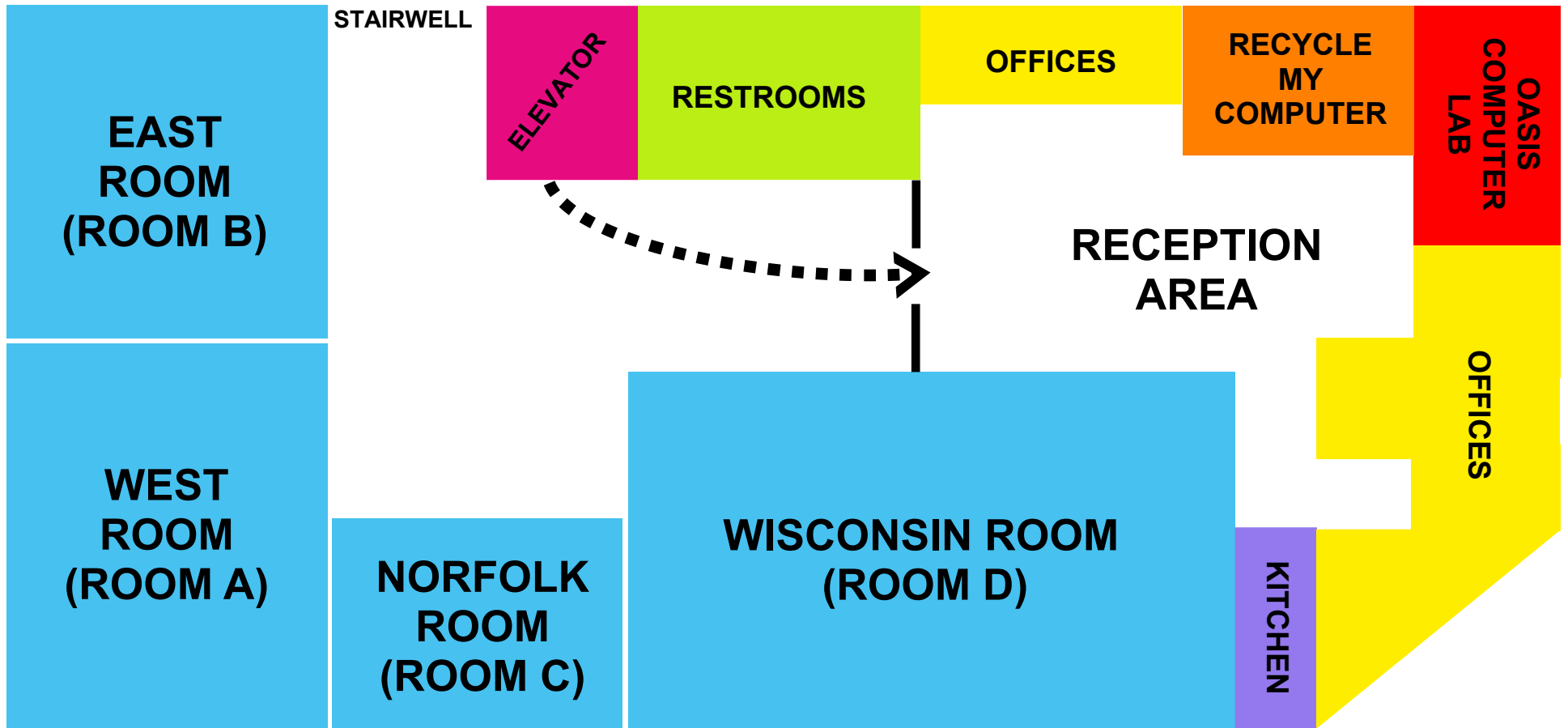

- | | | | | | |
|---|---------------|---|--------------------|---|---------|
|  | LECTURE ROOMS |  | RECYCLEMYCOMPUTER |  | KITCHEN |
|  | ELEVATOR |  | OASIS COMPUTER LAB | | |
|  | RESTROOMS |  | OFFICES | | |